

Quic 'n Easy Assembly: 47070007

NOTE: SHIM TOP WEAR BLOCK (ITEM #4) AS REQUIRED SO THAT DRAW BAR WELDMENT (ITEM #2) CAN SWING AND EXTEND FREELY WITH 1/32" MAX CLEARANCE AT WEAR BLOCK (ITEM #4).

ITEM #2 SHOWN WITHOUT REINFORCEMENT FLANGE

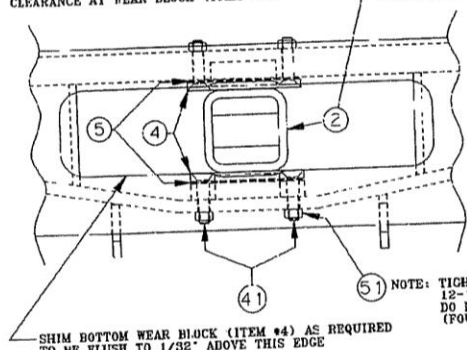

SHIM BOTTOM WEAR BLOCK (ITEM #4) AS REQUIRED TO BE FLUSH TO 1/32" ABOVE THIS EDGE

NOTE: TIGHTEN 5/16" NUT TO 12-15 FT-LBS DO NOT OVER TORQUE (FOUR PLACES)

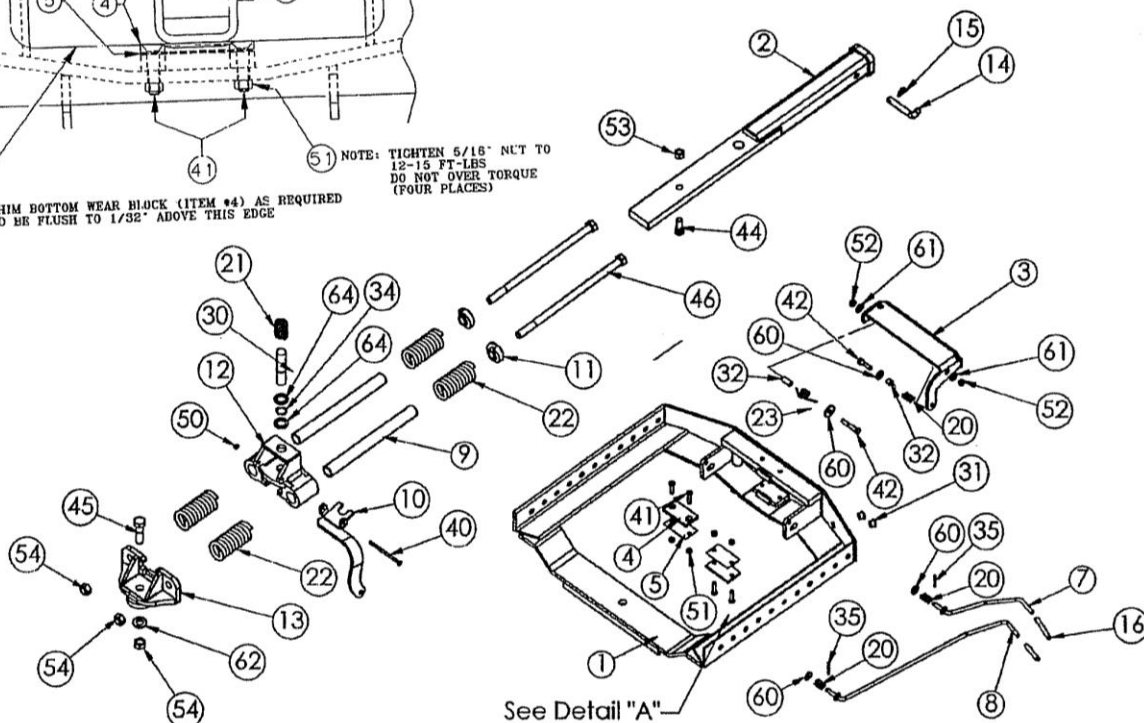

See Detail "A"

REF. NO.	PART NO.	QTY NO.	DESCRIPTION	REF. NO.	PART NO.	QTY NO.	DESCRIPTION
-	47090001	-	Quic 'n Easy Frame Assembly	30	47077250	1	Pin, Draw Bar Lock
1	47070007F	1	QE Frame Weldment	31	30003300	2	Grommet, Black Plastic Snap-In
2	47077460	1	Drawbar QE	32	44003802	2	Pivot Bushing, 1-1/8" Long
3	47077640DL1	1	Lock, Slide Swing QE/QCC	34	14610100	1	Snap Ring, Draw Bar Pin
4	47077425	2	Wear Block QE	35	14700502	2	5/32" x 1-1/2" Cotter Pin
5	47077426	2	Shim .020" QE/QCC	40	16004184	2	1/4"-20 x 4-1/2" NC Hex Bolt
7	47077485	1	Handle, Stop Lock QE	41	16900000	4	5/16"x1-1/2" NC FHMS
8	47077480	1	Handle, Pin Lever QE	42	16006095	2	3/8"-16 x 2-1/4" NC Hex Bolt
9	47070010	2	Pipe fabricated	44	16010075	1	5/8"-11 x 1-1/2" NC Hex Bolt
10	47077470	1	Lever	45	16912115	1	3/4"-10 x 2-3/4" GRD 8 HHCS
11	20092160	2	Spring Retainer Casting	46	16912645	2	3/4" x 16" NC Hex Bolt
12	20092161	1	Spring Mount Casting	50	14110401	1	1/4" NC Hex Nyloc Locknut
13	20092170	1	Towbar Mounting Casting	51	14010501	4	5/16" NC Hex Nyloc Locknut
14	47077915	1	Receiver Pin 5/8" Dia.	52	14110601	2	3/8" NC Hex Nyloc Locknut
15	14710610	1	3/16" Dia. Klik Pin	53	14111001	1	5/8" NC Hex Nyloc Locknut
16	30003400	2	Plastic handle grip .375X3 red	54	14111201	3	3/4" NC Hex Nyloc Locknut
20	24108100	3	Compression Spring, Handle	60	17006001	4	3/8" Washer
21	24111201	1	Compression Spring, Lock Pin	61	17006001	2	3/8" Washer
22	24140610	4	Compression Spring, Cushion	62	17112000	1	3/4" SAE ZP Flat Washer
23	24512512	1	Torsion Spring, Slide Lock	64	17616011	2	1" Machine bushing Washer, 10 ga.